



## DW Series Shredders

***Doppstadt* US**

**SHRED. SCREEN. GRIND.**



#### HINGED RADIATOR WITH AUTOMATIC REVERSING FAN

The radiator is easily accessible and self-cleaning.



#### FEED HOPPER, SHAFT AND SHREDDING COMB

Roller teeth tear the material through the hydraulically controlled shredding comb. The comb opens automatically in case of large unshreddable contaminants in order to protect the machine and reduce wear. All the wear parts are quickly replaceable.

#### REMOTE CONTROL

All important functions of the shredder can be operated with the 16-channel remote control, e.g. by the wheel loader operator.

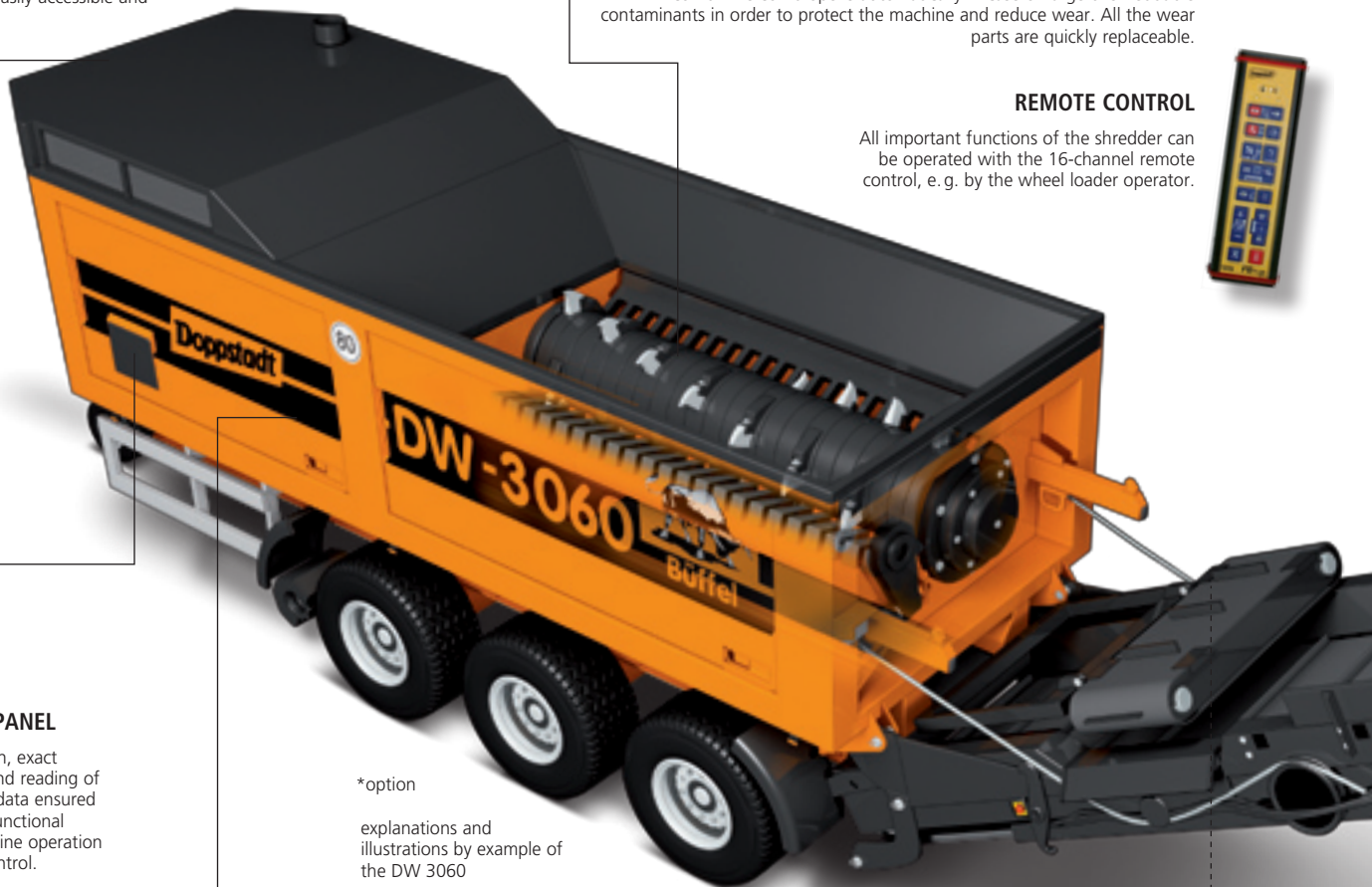

#### CENTRAL CONTROL PANEL

Easy operation, exact adjustment and reading of the machine data ensured with a multifunctional display. Machine operation by remote control.



\*option

explanations and illustrations by example of the DW 3060

### Exclusive Combination of Well-Engineered Features

All Doppstadt products deliver precision engineering and value-adding innovation. DW shredders are designed to provide powerful primary reduction performance through a tremendously fuel-efficient and easy-maintenance process. Creative features ensure continuous performance regardless of hidden contaminants.

#### MAINTENANCE

Large doors for optimal maintenance.

#### LOWER DISCHARGE CONVEYOR

Below the shredding unit, the material is transported by a separately controlled discharge conveyor.





# A Broad Range of Effective Applications

## DW Series Shredders Don't Quit. Period.

Even the most robust demolition or land clearing debris is no match for a Doppstadt DW Series slow-speed shredder. With our exclusive breakaway shredding comb, contaminants and other tramp metal simply pass through the shaft with no harmful effect. The slow-speed, high-torque action of the tooth and comb shaft powers through your material with ease.

## Boosting Your Bottom Line



### REAR CONVEYOR

The material is discharged by a rear conveyor. Fe-separation by overband magnet\* or magnetic pulley\*.

With a rotational speed of only 32 rpm, DW shredders generate high torque and power through extremely fuel-efficient engineering. The result is high-volume primary reduction performance with a low production cost. And because of the durability of the slow-speed design, wear costs are significantly reduced. Material reduction with cost reduction: Doppstadt shredders will make you more money.

**C&D debris:** reduce C&D volume by 50% or more with no concern for contaminants

**wood waste:** process wood with less fines, a tremendous advantage when selling material by volume

**compost:** larger product size from shredders increases air and water flow to cure compost faster

**MSW:** reduce material volume by 30% and improve compaction to increase landfill capacity

**land clearing:** cut transportation costs by reducing logs and stumps without concern for dirt or rocks

**rail ties:** process 400 ties per hour for valuable fuel production without concern for spikes or plates

**biofuel:** maximize BTU value of biofuel with a more uniform primary reduction

**tires:** shred tires to increase material per yard to save on transportation costs

## DW 2560

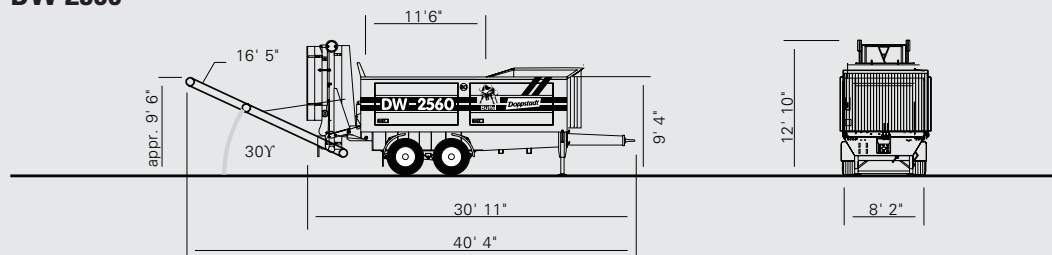

Model weight	41,890 lb.
Engine	MB OM 460 LA
HP	390
Exhaust Level	TIER 3
Fuel Tank	80 gal.
Speed	31 rpm
Conveyor Width	48"

Also available on tracked chassis

## DW 3060SA

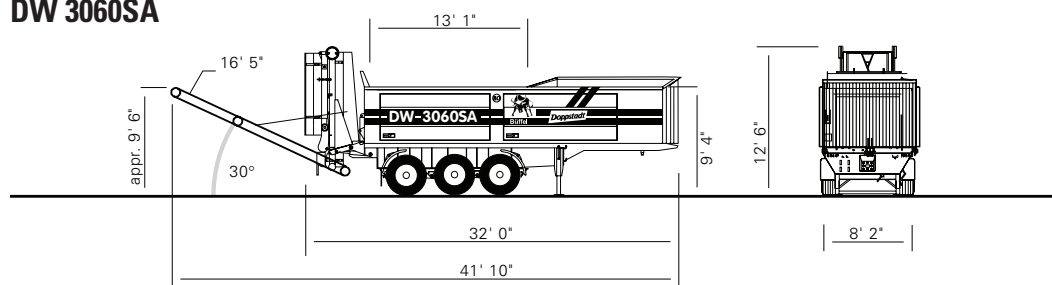

Model weight	52,910 lb.
Engine	MB OM 460 LA
HP	430
Exhaust Level	TIER 3
Fuel Tank	2 x 80 gal.
Speed	32 rpm
Conveyor Width	48"

Also available on tracked chassis

## DW 3060K

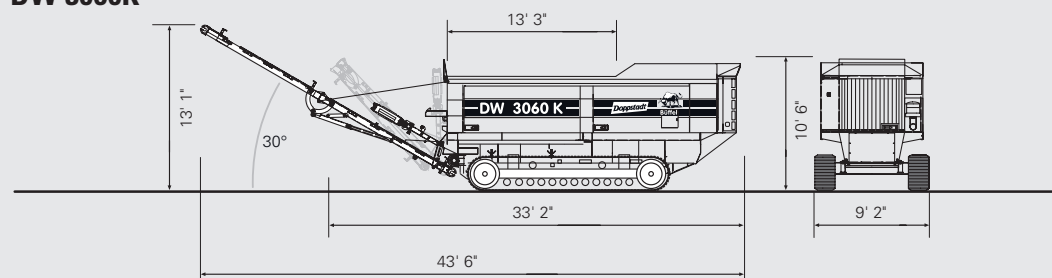

Model weight	66,139 lb.
Engine	MB OM 460 LA
HP	430
Exhaust Level	TIER 3
Fuel Tank	2 x 80 gal.
Speed	31 rpm
Conveyor Width	48"

## DW 3080K

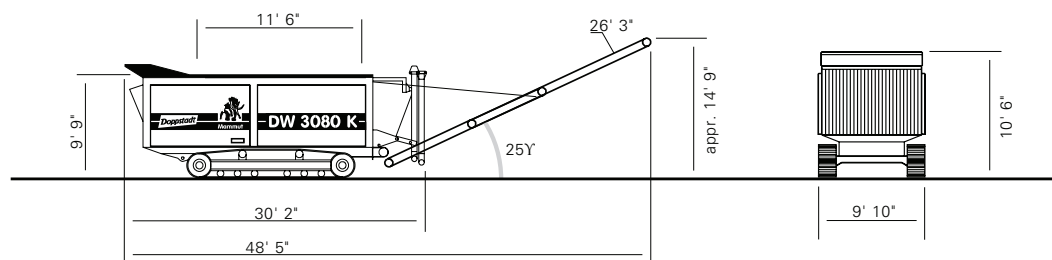

Model weight	100,300 lb.
Engine	MB OM 502 LA
HP	610
Exhaust Level	TIER 3
Fuel Tank	2 x 80 gal.
Speed	30 rpm
Conveyor Width	48"



SHRED. SCREEN. GRIND.

### DoppstadtUS

1057 Jaycox Rd.  
Avon, OH 44011

440.937.3225 phone  
440.937.3411 fax

sales@doppstadtus.com

[www.doppstadtus.com](http://www.doppstadtus.com)